

# NCC COMPLIANT AS5216 CONFORMING

## SCREW ANCHOR EXTERNAL THREAD

Range 6mm

**Ceramic Coated**  
Damp, external applications

### FEATURES & BENEFITS

- Ideal for light duty safety critical & fire rated applications.
- Intended working life of 50 years.
- High tensile single piece anchor, cuts thread into concrete.
- ETA rating - Seismic C1.
- Fire rating to 120 minutes.

### APPLICATIONS/TRADES

- HVAC Duct work.
- Fire protection.
- Cable tray applications.

### COMPLIANCE



**AS5216**

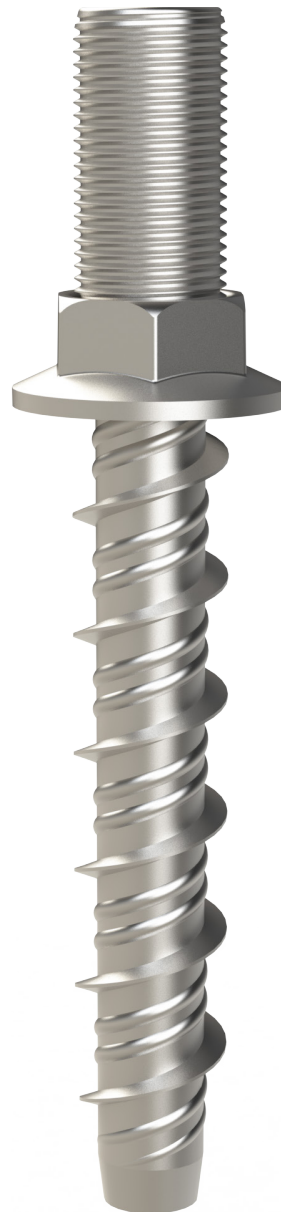

M8 or M10  
external thread



Triple Hi-Lo thread  
for improved tensile  
performance



Tapered tip for simpler  
installation



# SCREW ANCHOR

## EXTERNAL THREAD

### NCC COMPLIANT | AS5216 CONFORMING

#### RANGE

Product Code	Pack Qty	ETA Cert'n level	Anchor length (mm)	Drill hole Ø (mm)	Drill hole depth (mm)	Minimum concrete thickness (mm)	External thread size
			$l_t$	$d_o$	$h_1$	$h_{min}$	
ASE0R06055ETA	50	C1	55	6	65	100	M10
ASE8R06055ETA	50	C1	55				M8

#### INSTALLATION

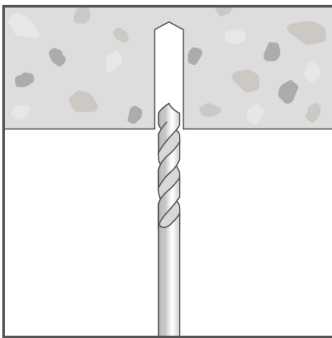

Drill hole into substrate to the specified diameter and depth.

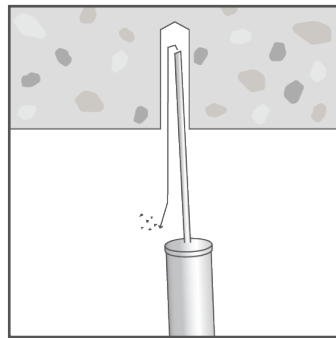

Clear hole of drilling debris.

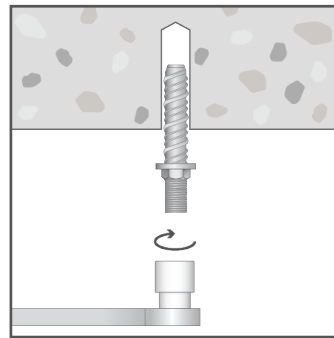

Insert anchor into hole and screw in using spanner, socket or an impact wrench. Apply constant forward pressure when driving and tighten to the specified torque.

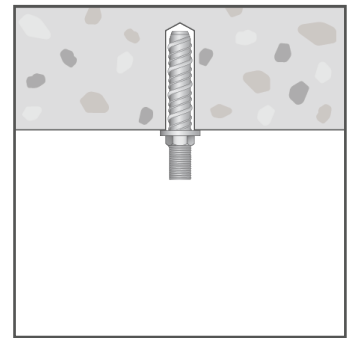

Use hand tools when removing the anchor. Do not remove with power tools if resetting the anchor.

# SCREW ANCHOR EXTERNAL THREAD NCC COMPLIANT | AS5216 CONFORMING

## PRODUCT INSTALL & PERFORMANCE INFORMATION

Product Code	Anchor length (mm)	External thread size	Drill hole depth (mm)	Minimum concrete thickness (mm)	Socket size AF (mm)	Installation torque (Nm)	Design Capacities	
							Uncracked concrete - tension (kN)	Uncracked concrete - shear (kN)
							$N_{Rd}$	$V_{Rd}$
	$l_t$		$h_1$	$h_{min}$	SW	$T_{inst}$		
ASE0R06055ETA	55	M10	65	100	17	15	6.1	6.0
ASE8R06055ETA	55	M8			13			

Note: Concrete cylinder compressive strength = 32MPa.  
 Single anchor capacity - no nearby edge, minimum recommended concrete thickness.  
 For combined load cases (tension & shear) - must also comply with  $(N^* / N_{Rd}) + (V^* / V_{Rd}) \leq 1.2$ .

**Important Disclaimer:** Product performance information contained herein is based on ETA certificate data and AS5216:2021 inputs as appropriate. Capacity information is limited to very simple load case configurations and is provided to enable a relative comparison within and across product ranges. The design of an anchoring solution for a particular application should be conducted by an appropriately qualified design professional.